



# Water Well And Pump Record

Completion is required under authority of Part 127 Act 368 PA 1978.



Failure to comply is a misdemeanor.

Import ID:

Tax No: 006-016-300-10		Permit No: 30961		County: Oceana		Township: Golden		
Well ID: 64000010163				Town/Range:	Section:	Well Status:	WSSN:	Source ID/Well No:
				15N 18W	16	Active		
Elevation:				Distance and Direction from Road Intersection:				
Latitude: 43.695211				34TH AVE SOUTH OF DEER RD				
Longitude: -86.472386				Well Owner: DONALD VANATTA				
Method of Collection: Interpolation-Map				Well Address:			Owner Address:	
				2743 N WILSON AVE			641 N GOLDEN SANDS DR	
				MEARS, MI			MEARS, MI	

Drilling Method: Rotary	Pump Installed: Yes	Pump Installation Only: No
Well Depth: 50.00 ft.	Pump Installation Date:	HP: 0.50
Well Type: New	Manufacturer: F.E. Myers	Pump Type: Submersible
Casing Type: PVC plastic	Model Number: 2 WIRE	Pump Capacity: 12 GPM
Casing Joint:	Drop Pipe Length: 34.00 ft.	Pump Voltage: 220
Casing Fitting: Unknown	Drop Pipe Diameter:	Drilling Record ID:
Diameter: 5.00 in. to 45.00 ft. depth SDR: 21.00	Draw Down Seal Used: Unknown	
Borehole: 8.50 in. to 50.00 ft. depth	Pressure Tank Installed: Yes	
	Pressure Tank Type: Unknown	
	Manufacturer: Well-X-Trol	
	Model Number: 202UG	Tank Capacity:
	Pressure Relief Valve Installed:	

Static Water Level: 22.00 ft. Well Yield Test: Pumping level 35.00 ft. after 1.00 hrs. at 30 GPM Yield Test Method: Air Unrestricted Flow Rate:	Formation Description	Thickness	Depth to Bottom
	Sand	21.00	21.00
	Red Clay	17.00	38.00
	Sand & Clay	5.00	43.00
	Sand	7.00	50.00

Screen Installed: Yes	Filter Packed: Yes
Screen Diameter: 3.75 in.	Blank:
Screen Material Type: Stainless steel-wire wrapped	
Screen Installation Type: Unknown	
Slot Length Set Between	
10.00 5.00 ft. 45.00 ft. and 50.00 ft.	
Fittings: Neoprene packer	

Grouting Material	Bags	Additives	Depth
Bentonite slurry	2.00	Unknown	0.00 ft. to 40.00 ft.

Wellhead Completion: Pitless adapter

Nearest Source of Possible Contamination:			Drilling Machine Operator Name: RON LAURITZEN
Type	Distance	Direction	Employment: Unknown
Septic tank	80 ft.	East	

Contractor Type: Water Well Drilling Contractor Reg No: 62-2050  
 Business Name: LAURITZEN WELL DRILLING  
 Business Address: 6433 S FITZGERALD, FREMONT, MI

**Water Well Contractor's Certification**  
 This well and/or pump installation was performed under my registration.

Signature of Registered Contractor \_\_\_\_\_ Date \_\_\_\_\_

General Remarks:  
 Other Remarks:

# PERMIT TO CONSTRUCT:

SEWAGE TREATMENT SYSTEM  
 WELL

DISTRICT HEALTH DEPARTMENT NO. 5  
Lake, Newaygo, & Oceana Counties

PERMIT NO. 30961

### PERMIT FOR FACILITIES AT:

STREET ADDRESS 2738 34th Ave. N.  
TOWNSHIP Golden  
SECTION # 16  
PROPERTY OWNER Donald Vanatta

### PERMIT ISSUED TO:

NAME Northwind Construction  
MAILING ADDRESS [REDACTED]  
TELEPHONE [REDACTED]

### DESIGN CRITERIA:

- SINGLE FAMILY NO. OF BEDROOMS \_\_\_\_\_
- GARBAGE DISPOSAL  WATER SOFTENER
- TOILET-SHOWER-LAVATORY IN BASEMENT
- MULTIPLE DWELLING GAL/DAY \_\_\_\_\_
- OTHER COMMERCIAL GAL/DAY \_\_\_\_\_

SOIL BORING NO. 1 NO. 2 NO. 3  
0-62" Med & Coarse Sands  
met @ 30"

SEASONAL WATER TABLE 30"

OTHER NOTES Pole Building for storage - one bathroom

### PERMIT TO INSTALL, CONSTRUCT OR REPLACE

EXPIRES ONE (1) YEAR AFTER DATE OF ISSUE

SEPTIC TANK SIZE 1400 GAL.  
 DRAINAGE SYSTEM 300 # 12'x25' w/4  
latrines 3' on center

WELL CONTRACTOR Pittler/Adler

### SPECIAL CONDITIONS OF PERMIT: (See reverse side)

*Bottom of drain to sit on top of existing grade - no deeper!!  
Will need to adjust plumbing to achieve gravity flow to system  
75' isolation between well & septic system.  
Call for final inspection before covering system.*

APPROVED  DENIED \_\_\_\_\_

Greg Wise, R.S. 7/24/96  
HEALTH DEPT. REPRESENTATIVE DATE OF ISSUE

SEE REVERSE SIDE

Rev. 695

### PLOT PLAN:

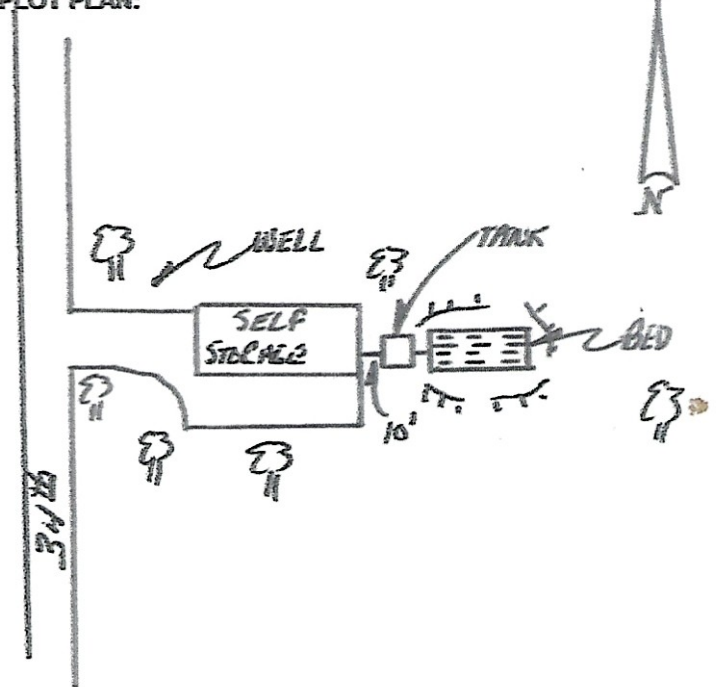

### CERTIFICATE OF INSPECTION

INSPECTION TYPE F DATE 8/8/96 BY Wise  
INSPECTION TYPE \_\_\_\_\_ DATE \_\_\_\_\_ BY \_\_\_\_\_

TREATMENT SYSTEM TYPE DB.

FINAL DISPOSAL 12'x25' ISOLATION DIST W/C SEPTIC TANK 1400 GAL

NOTES 8' below grade - ok.  
APPROVED BY Wise DATE 8/8/96 CONTRACTOR Northwind

TYPE: A = Affidavit, P = Partial, F = Final  
WELL LOG INSPECTION DATE 10/28/96 BY \_\_\_\_\_

\*PLEASE HAVE YOUR WELL DRILLER FILL OUT AND RETURN TO THE HEALTH DEPARTMENT. THANK YOU.

TAX NO: 64-06-016-300-10

MICHIGAN DEPARTMENT OF PUBLIC HEALTH WATER WELL AND PUMP RECORD

PERMIT NO: 30961 Issued 9/26/96 Budise

1. LOCATION OF WELL
County Oceana
Township Name Golden
Fraction 1/4 1/4 1/4
Section No. 16
Town No. 15N
Range No. 18W

Distance and Direction from Road Intersection
34th Ave. south of Deer Rd.

Street Address & City of Well Location
2738 N. 34th Ave.

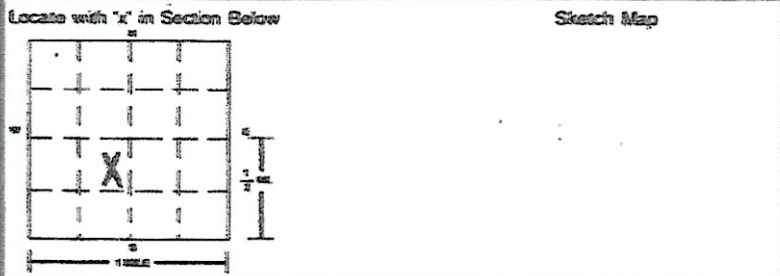

3. OWNER OF WELL Donald Vanatta
Address 641 N. Golden Sands Dr.
Mears, MI 49436
Address Same as Well Location Yes No

4. WELL DEPTH: 50 ft
Date Completed 8/13/96
New Well Replacement Well

5. Cable Tool Rotary Driven Dug
Hollow Rod Auger/Bored Jetted

6. USE: Household Type I Public Type III Public
Irrigation Type IIa Public Heat Pump
Test Well Type IIb Public

7. CASING: Steel Threaded Height: Above/Below Surface: 1 ft
Diameter: 5 in. to 45 ft. depth
Plastic Welded
Other
BOREHOLE: Diameter: 8 1/2 in. to 50 ft. depth
Drive Shoe Shale Packer

Table with 3 columns: FORMATION DESCRIPTION, THICKNESS OF STRATUM, DEPTH TO BOTTOM OF STRATUM. Rows include SAND, RED CLAY, SAND + CLAY MIX, SAND.

8. SCREEN: Not installed Gravel-Packed
Type S-Finless Diameter 3.75
Slot Gauge 10 Length 5
Set Between 45 ft. and 50 ft.
FITTINGS: K-Packer Bremer Check
Blank Above Screen

9. STATIC WATER LEVEL: 23 ft. Below Land Surface Flowing

10. PUMPING LEVEL: Below Land Surface
35 ft. After 1 hrs. Pumping at 20 G.P.M.
Plunger Bailor Air Test Pump

11. WELL HEAD COMPLETION:
Pileless Adapter 12" Above Grade
Basement Offset Well House

12. WELL GROUTED? No Yes From 0 to 40 ft.
Neat Cement Bentonite Other
No. of Bags 2 Additives

13. NEAREST SOURCE OF POSSIBLE CONTAMINATION:
Type SEPTIC Distance 80 ft. Direction E
Type Distance ft. Direction

15. ABANDONED WELL PLUGGED? Yes No
Casing Diameter in. Depth ft.
PLUGGING MATERIAL: Neat Cement Bentonite Slurry
Cement/Bentonite Slurry Concrete Grout Bentonite Chips
No. of Bags Casing Removed? Yes No

14. PUMP: Not installed Pump Installation Only
Manufacturer's Name MYERS
Model Number 2 WIRE HP 1/2 Volts 220
Length of Drop Pipe 34 ft. Capacity 12 G.P.M.
TYPE Submersible Jet Other
PRESSURE TANK:
Manufacturer's Name WELL-A-TANK
Model Number 20246 Capacity Gallons

16. REMARKS: (Elevation, Source of Data, etc.)

15. WATER WELL CONTRACTOR'S CERTIFICATION:
This well was drilled under my jurisdiction and this report is true to the best of my knowledge and belief.
Registered Business Name: LAZARSEN Well Drilling Registration No: 7058
Address: 6433 S FITZGERALD Fremont
Signed: [Signature] Date: 9-27-96
Authorized Representative

17. DRILLING MACHINE OPERATOR:
Employee Subcontractor
Name: R.H. LAZARSEN